

MORSA AUTOCENTRANTE / SELF-CENTERING VISE

IDEALE PER CENTRI A 5 ASSI
IDEAL FOR 5 AXIS MACHINING CENTRES

COMPATTE, RIGIDE & PRECISE
COMPACT, RIGID & ACCURATE

TOP JAW
INSERTS

5 AXIS
MACHINE

ZERO POINT
READY

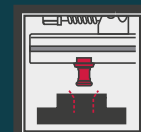

Art.650

Azionamento manuale - Serraggio meccanico
 Manual Control - Mechanical Clamping

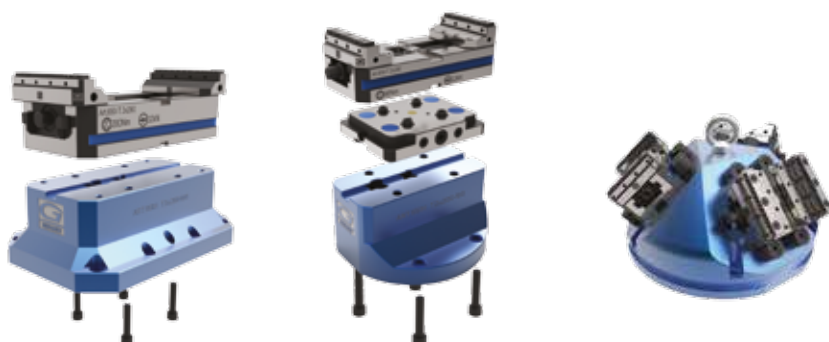

Example 1

Example 2

Example 3

La novità assoluta per centri a 5 assi e sistemi multipli sono le morse autocentranti Compact Grip. Il loro nome accosta le principali peculiarità della morsa date dall'estrema compattezza e maneggevolezza al nome del sistema di inserti che adotta, cosiddetto "GRIP". Questo sistema consiste in una gamma di inserti ganascia modulari montati sopra al corpo ganascia principale con la funzione di serrare il particolare da lavorare tramite dei dentini affilati o conformati a seconda del tipo di materiale e di durezza.

The absolute news for 5 axis machine centres and new multiclamping system are the self-centering Compact Grip vises. Their name identifies the main vise features which are the extreme compactness and easiest handling and the system of inserts which it adopts, so called "GRIP". This system includes a range of jaw inserts assembled on the top of the main jaw with the function of clamping the workpiece through sharp or duly shaped teeth according to the material type and hardness to clamp.

MORSA AUTOCENTRANTE CON GANASCE REVERSIBILI

Ideale Per Centri A 5 Assi

Tipo (grandezza) morsa / Vise (type) size

Art. 650

Tipo / Type **1x120**

Example 1



Art. 651H

Tipo / Type **1**

Rialzo Semplice
Simple Riser

kN	1 12 kN		
A	48	88	128
A1		6	
W		50	
B		65	
C		45	
C1		53	
C2		61	
D		80	
E	80	120	160
F		52	
L		12	
L1		M8	
kg	1,8	2,6	3,4
Cod.	7.65.01080	7.65.01120	7.65.01160

Art. 650

Tipo / Type **2x160**

Example 1

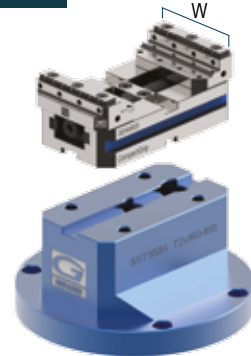

Art. 651H

Tipo / Type **2**

Rialzo Semplice
Simple Riser

Tipo / Type **1&2** Interasse - Pitch: **52mm**

A	150
B	27
C	100
D	156
D1	116
E	190
kg	3
Art. 660	Cod. 9.66.05200
kg	5
Art. 661H	Cod. 9.66.1H100

NUOVA PIASTRA DI ADATTAMENTO !!
NEW ADAPTING PLATE !!

Consente di ridurre la distanza tra i tiranti da **96 mm a 52 mm**

It allows to reduce the pull studs distance from **96 mm to 52 mm**

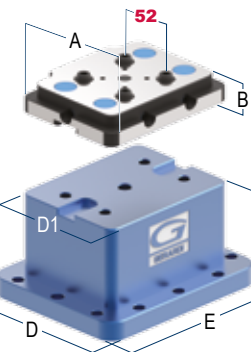
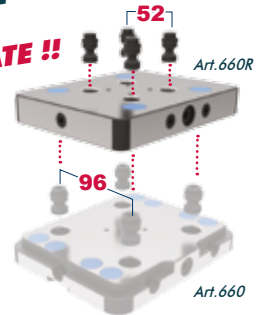

Art. 660

Tavola cambio rapido
Quick change table

Art. 661H

Rialzo in alluminio per tavola cambio rapido
Simple aluminum riser for quick change table

Example 2

Tipo - Type 1

Vite TPF14 - Passo 2mm
Screw TPF14 - Pitch 2mm

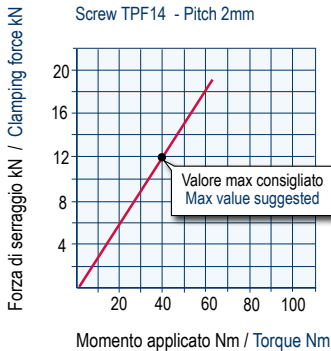

Tipo - Type 2

Vite TPF18 - Passo 2mm
Screw TPF18 - Pitch 2mm

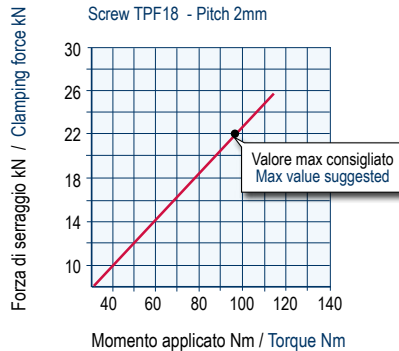

Tipo - Type 3

Vite TPF24 - Passo 2mm
Screw TPF24 - Pitch 2mm

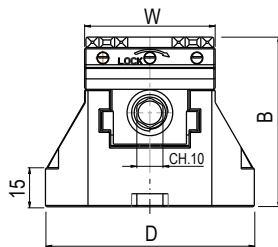
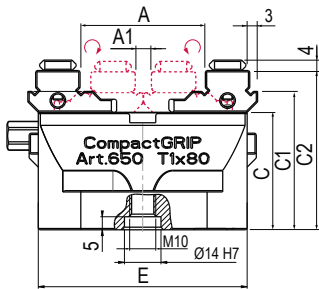
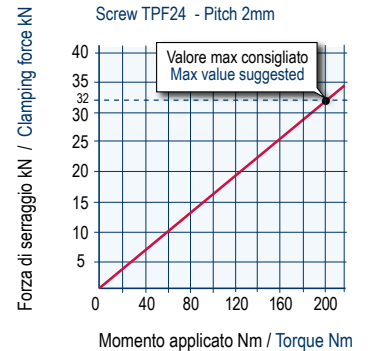

Tipo 1
Type 1

DOTAZIONE STANDARD - STANDARD EQUIPMENT

USARE STAFFE - USE SIDE CLAMPS

Art.298 Tipo / Type - **1xM10 / 1xM12 / 1xM16**



SELF-CENTERING VISE WITH REVERSIBLE JAWS

Ideal For 5 Axis Machining Centres

	2			
kN	22 kN			
A	96	136	176	216
A1		10		
W		88		
B		65		
C		38		
C1		51		
C2		61		
D		90		
E	120	160	200	240
F		52		
L		12		
L1		M8		
kg	3,6	4,4	5,2	5,8
Cod.	7.65.02120	7.65.02160	7.65.02200	7.65.02240

	3				
	32 kN				
Art. 650	<i>Tipo / Type 3x310</i>				
Example 1	126	176	226	276	326
			10		
			123		
			89		
			57		
			75		
			85		
			125		
	160	210	260	310	360
			96		
			16		
			M10		
Art. 651H	<i>Tipo / Type 3</i>				
<i>Rialzo Semplice</i>	9,1	10,9	12,8	14,8	17
<i>Simple Riser</i>	7.65.03160	7.65.03210	7.65.03260	7.65.03310	7.65.03360

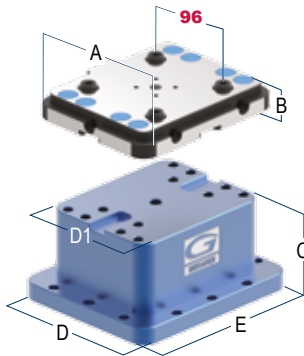
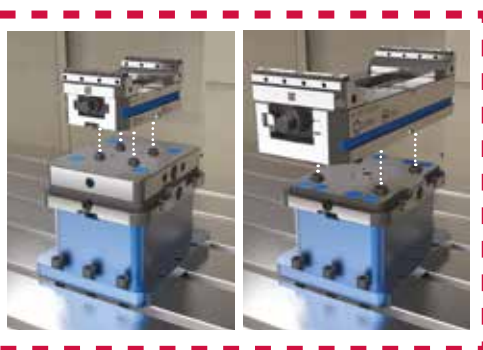

	<i>Tipo / Type 3 Interasse - Pitch: 96mm</i>				
Art. 660	<i>Tavola cambio rapido</i>				
<i>Quick change table</i>	190	27	100	176	136
			210		5,2
			9.66.09600		
Art. 661H	<i>Rialzo in alluminio per tavola cambio rapido</i>				
<i>Simple aluminum riser for quick change table</i>	6,5				
Example 2	9.66.1H200				

Nata espressamente per i centri a 5 assi, la gamma CompactGRIP permette di intervenire sulle 5 facce del particolare in lavorazione con riferimenti precisi in spazi contenuti garantendo usure inesistenti e grande rigidità.

- Usura inesistente HRC 58 ±2
- Rapidità nei serraggi
- Modularità & Versatilità
- Rigidità & Sicurezza grazie alle ganasce integrali
- Design compatto e maneggevolezza
- Tolleranze entro ±0,02 mm
- Ancoraggio diretto o tramite staffe
- Costruzione solida e compatta a massima apertura rispetto agli ingombri
- Autocentranti con serraggi concentrici dall' esterno all' interno e viceversa
- Inserti reversibili completamente dentati da un lato e scaricati al centro dall'altro
- Fori frontali passanti per applicazioni personalizzate (piastrine, puntali)

Designed for 5 axis machines, CompactGRIP series of vises allow machining operations on the 5 workpieces sides with perfect alignment in a space saving design, extremely high wear resistance, with reduced deflection.

- No Wear HRC 58 ±2
- Quick clamping operation
- Modularity & Versatility
- Rigidity & safety thanks to the solid jaws
- Space saving design & handy
- Highest accuracies ± 0,02 mm
- Direct vise set-up or through vise clamps
- Solid and rigid construction and maximum clamping ratio to the total length
- Self-centering vise for clamping parts on outside or inside (by reversing jaw plates)
- Double sided top jaw inserts with full work piece contact on one side and partial on the other
- Front through holes for customized applications (plates, points, etc..)

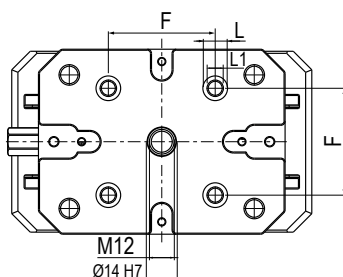
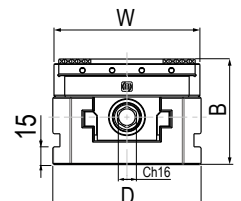
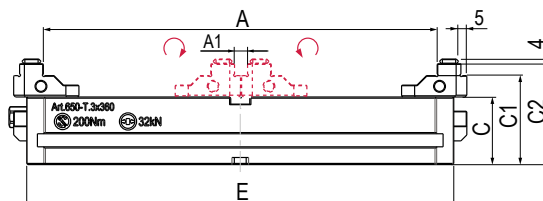
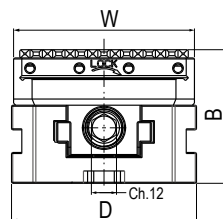
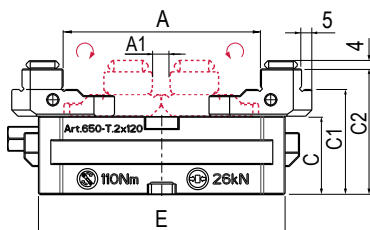

Tipo Type 2

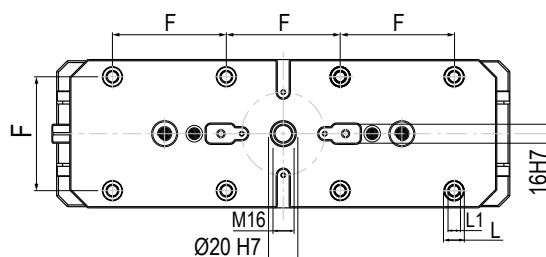

Tipo Type 3

AMPIA GAMMA DI INSERTI GANASCE PER MORSE Art.650 WIDE RANGE OF TOP JAW INSERTS FOR VISES Art.650

Inserti reversibili lisci, ruvidi o completamente dentati da un lato e scaricati al centro dall' altro lato
Double sided top jaw inserts with full work piece contact on one side and partial on the other

Coppie di inserti ganasce - Pair of top jaw inserts

Art. 650S

LISCI + RUVIDI - SMOOTH + ROUGH

Materiali teneri e lavorazioni finali
Soft material clamping and final machining

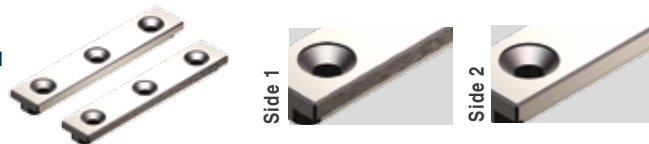

Art. 650R

CODA DI RONDINE - DOVE TAIL

Miglior presa pezzo
Best workpiece clamping

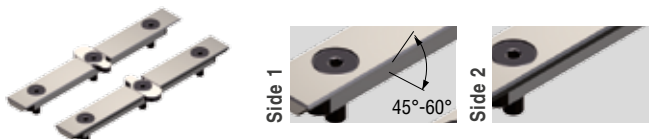

Art. 650T G01

GRIP (Passo - Pitch 1,5mm)

Per materiali di durezza normale
For standard workpieces hardness clamping

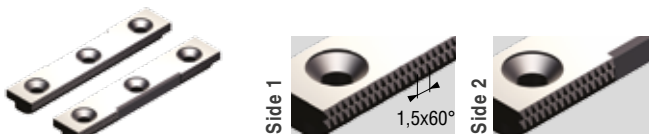

Art. 650T G02

GRIP (Passo - Pitch 2mm)

Per materiali di notevole durezza
For hardened workpieces clamping

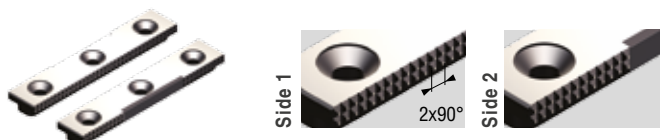

Art. 650T G11

GRIP (Passo - Pitch 11mm)

Per materiali teneri
For soft material clamping

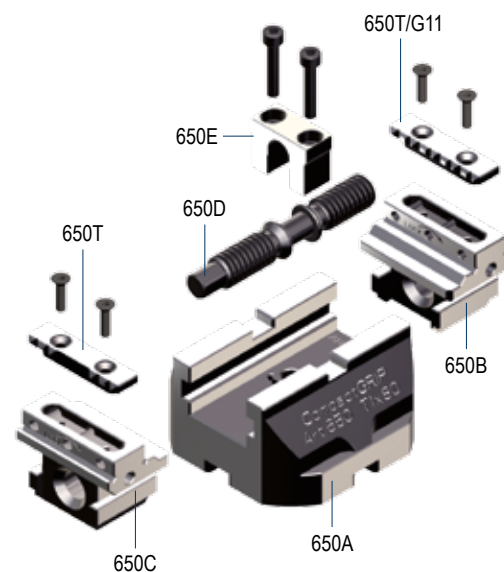
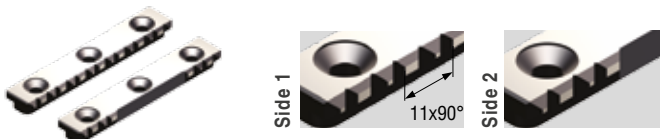

Compatibility

Massima compatibilità con i sistemi di cambio pallet già esistenti sul mercato

Max compatibility with the most popular pallet change systems.



Risers

Grazie ai rialzi Compact è possibile lavorare parti del particolare difficili da raggiungere

By the Compact risers it's possible machining areas usually hard to reach.



Versatility

Versatilità grazie alle ganasce reversibili e alle 4 opzioni di posizionamento della base (90°)

Versatility also thanks to the reversible jaws and to the 4 base positions option (90°)



Clamping Power

La posizione della vite di serraggio garantisce una maggior forza di serraggio.

Much higher clamping power than the existing vises thanks to the clamping screw design